

## FITTING INSTRUCTION

Clamp mark in acc. with		Cables joining
ISO	PN	
1	L	Left directional lights
2	+	Rear fog lights
3	31	Ground
4	R	Right directional lights
5	58R	Right side parking lights
6	54	Stoplights
7	58L	Left side parking lights

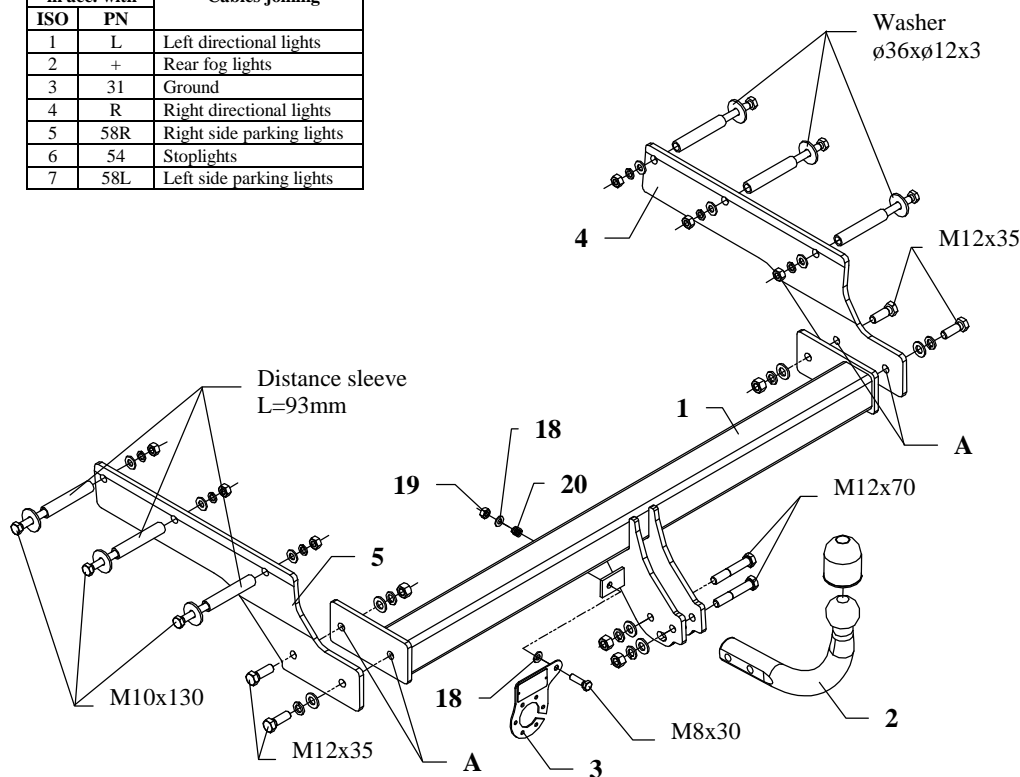

This towbar is designed to assembly in following car:  
**FORD MONDEO ESTATE**, produced since 10.2000 till 12.2006,  
 catalogue no. **C38** and is prepared to tow trailers max total weight **1800 kg**  
 and max vertical load **75 kg**.

### *From manufacturer*

Thank you for buying our product. Their reliability has been confirmed in many tests. Reliability of towbar depends also on correct assembly and right operation. For this reasons we kindly ask to read carefully this instruction and apply to hints.

*The towbar should be install in points described by a car producer.*

## The instruction of the assembly

1. From below the car (right side) unscrew the plastic cover mask.
2. Unscrew the bumper only from below (long element of masking wall) and then apply the template to cut the bumper.
3. Let down the muffler from rear handle and unscrew the thermal sheet.
4. Put distance sleeves  $\varnothing 17\text{mm}$ ,  $L=93\text{mm}$  (pos. 6) into chassis members (in designed by producer places).
5. Fix the bracket (pos. 5) marked as **C38L** on the left side in the internal side of the chassis with bolts  $M10 \times 130\text{mm}$  (pos. 10).
6. Fix the bracket (pos. 4) marked as **C38R** on the right side in the internal side of the chassis with bolts  $M10 \times 130\text{mm}$  (pos. 10).
7. To so prepared brackets (pos. 4 and 5) fix the main bar of the towbar (pos. 1) using bolts  $M12 \times 35\text{mm}$  (pos. 9). You should pull element of masking wall to make this.
8. Fix tow ball (pos. 2) using bolts  $M12 \times 70\text{mm}$  (pos. 8) from accessories.
9. Fix the socket plate (pos. 3) as shown on the drawing.
10. Tighten all bolts according to the torque shown in the table.
11. Connect electric wires of 7-poles socket according to the instruction of the car. (Recommend to make at authorized service station).
12. Complete paint layer damaged during installation.

### Torque settings for nuts and bolts (8,8):

<b>M6</b> - 11 Nm	<b>M8</b> - 25 Nm	<b>M10</b> - 50 Nm
<b>M12</b> - 87 Nm	<b>M14</b> - 138 Nm	<b>M16</b> - 210 Nm

### NOTE

After install the towbar you should get adequate note in registration book (at authorised service station).The car should be equipped with:

- Indicators
- Tow mirrors

After 1000km of exploitation check all bolts and nuts. The ball of towbar must be always kept clear and conserve with a grease.

## Towbar accessories:

Pos. 1 Name: Main bar Quantity: 1	Pos. 5 Name: Left bracket Quantity: 1	Pos. 10 Name: Bolt 8,8 B Quantity: 6 Dim.: M10x130mm	Pos. 16 Name: Spring washer Quantity: 6 Dim.: $\phi$ 10,2 mm
Pos. 2 Name: Tow ball Quantity: 1	Pos. 6 Name: Distance sleeve Quantity: 6 Dim.: $\phi$ 17,2x2,35, L=93	Pos. 11 Name: Nut 8 B Quantity: 4 Dim.: M12	Pos. 17 Name: Bolt 8,8 B Quantity: 1 Dim.: M8x30mm
Pos. 3 Name: Socket plate Quantity: 1	Pos. 7 Name: Washer Quantity: 6 Dim.: $\phi$ 36x $\phi$ 12x3	Pos. 12 Name: Nut 8 B Quantity: 6 Dim.: M10	Pos. 18 Name: Plain washer Quantity: 2 Dim.: $\phi$ 8,5 mm
Pos. 4 Name: Right bracket Quantity: 1	Pos. 8 Name: Bolt 8,8 B Quantity: 2 Dim.: M12x70mm	Pos. 13 Name: Plain washer Quantity: 6 Dim.: $\phi$ 13 mm	Pos. 19 Name: Nut 8 B Quantity: 1 Dim.: M8
	Pos. 9 Name: Bolt 8,8 B Quantity: 4 Dim.: M12x35mm	Pos. 14 Name: Plain washer Quantity: 6 Dim.: $\phi$ 10,5 mm	Pos. 20 Name: Spring Quantity: 1
		Pos. 15 Name: Spring washer Quantity: 6 Dim.: $\phi$ 12,2 mm	Pos. 21 Name: Ball cover Quantity: 1



## PPUH AUTO-HAK S.J.

Produkcja Zaczepów Kulowych  
Henryk & Zbigniew Nejman  
76-200 SŁUPSK ul. Słoneczna 16K  
tel/fax (059) 8-414-414; 8-414-413  
E-mail: [office@autohak.com.pl](mailto:office@autohak.com.pl)  
[www.autohak.com.pl](http://www.autohak.com.pl)

## Towing hitch (without electrical set)

Class: **A50-X** Cat. no. **C38**

Designed for:

Manufacturer: **FORD**

Model: **MONDEO**

Type: **ESTATE**

produced since 10.2000 till 12.2006

Technical data:

**D-value: 8,66 kN**

maximum trailer weight: **1800 kg**

maximum vertical cup load: **75 kg**

Approval number acc. to regulations EKG/ONZ 55.01: **E20-55R-01 0982**

## Foreword

This towing hitch is designed according to rules of safety traffic regulations. The towing hitch is a safety component and can be install only by qualified personnel. Any alteration or conversion of the towing hitch is prohibited and would lead to cancellation of design certification. Remove insulating compound and underseal from vehicle (if present) in the areas of the matting surfaces of the towing hitch. The vehicle manufacturer's specifications regarding trailer load and max. vertical cup mass are decisive for driving whereat values for the towing hitch cannot be exceeded.

*D-value formula:*

$$\frac{\text{Max trailer weight [kg]} \times \text{Max vehicle weight [kg]}}{\text{Max trailer weight [kg]} + \text{Max vehicle weight [kg]}} \times \frac{9,81}{1000} = D \text{ [kN]}$$